

Precision Stainless Steel Gas Mass Flow Meters

Features

- Direct monitoring of mass flow rate eliminates need for ancillary pressure and temperature sensing
- 316 Stainless-steel flow body accommodates most corrosive and toxic gas applications
- Suitable with pressures up to 500 psig (34 barg)
- Digital display of mass flow rate optional on flow body or in remote version for panel mounting
- Electronic output of mass flow rate for control or data-logging
- Large, straight sensor tube reduces pressure drop and permits cleaning
- Platinum sensor minimizes zero drift and ensures long-term repeatability
- Primary standard calibration ensures starting point accuracy and NIST traceability
- CE Approved
- Compact size for easy installation

SIERRA
INSTRUMENTS
THE MASS FLOW COMPANY

5 Harris Court, Bldg. L
Monterey CA 93940
831/373-0200
800/866-0200
FAX: 831/373-4402
www.sierrainstruments.com



For information online...
www.sierrainstruments.com

Model 820-S Top-Trak™



Description

Sierra Instruments' Model 820-S Top-Trak™ is designed for precise measurement of any process gas in ranges from 0 to 10 sccm to 0 to 500 slpm. Because all wetted materials are 316 stainless steel, the device accommodates most clean gases, including corrosives at pressures up to 500 psig (34 barg).

Top-Trak's outstanding accuracy is a function of a high-stability platinum flow sensor. This sensor has been continuously improved for many years to minimize long-term deviation (drift). The sensor's large internal diameter prevents the clogging and contamination often associated with capillary type thermal mass flow meters and creates minimum insertion pressure loss in your installation.

The Model 820-S optional display shows the mass flow rate directly in any user defined gas mass units. The instrument display is tiltable over 180° for easy viewing and can be removed for remote panel mounting. A 0-5 VDC or 4-20 mA linear output signal proportional to gas mass flow rate is provided for recording, data-logging or control.

Top-Trak's broad range of sizes, electronics, process connections and input/output options provide flexibility, versatility and ultimately, the ideal instrument package for your specific application.

The information contained herein is subject to change without notice.

Dimensions in inches (Millimeters)

Low Flow Body

FLOW RANGE		
	0-10 sccm	0-15 slm
Process Tubing	.25 (6.4)	.25 (6.4)

FITTING TYPE, .562-18 THREAD (1)			
	Compression .125 or .25	VCO(male) .25	VCR(male) .25
Dim. L	4.84 or 5.0 (122.9 or 127.0)	4.60 (116.8)	4.90 (124.5)

Medium Flow Body

FLOW RANGE, slm		
	0-15	0-100
Process Tubing	.25 or .375 (6.4 or 9.5)	.25 or .375 (6.4 or 9.5)

FITTING TYPE, .562-18 THREAD (1)			
	Compression .25 or .375	VCO(male) .25 or .375	VCR(male) .25 or .375
Dim. L	6.27 or 6.39 (159.3 or 162.3)	5.81 or 6.25 (147.6 or 158.8)	6.13 or 6.43 (155.7 or 163.3)

High Flow Body

FLOW RANGE, slm		
	0-100	0-500
Process Tubing	.375 or .50 (9.5 or 12.7)	.50 (12.7)

FITTING TYPE, .75-16 THREAD (1)			
	Compression .375 or .50	VCO(male) .375	VCR(male) .375
Dim. L	11.89 or 12.17 (302 or 309.1)	11.75 (298.5)	12.19 (309.6)

Note: (1) Metric fittings are available, consult factory.

Model 820-S – Side View

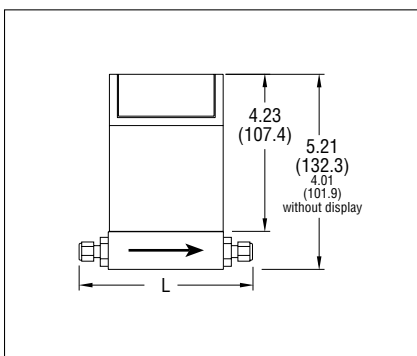

Model 820-S – Side View

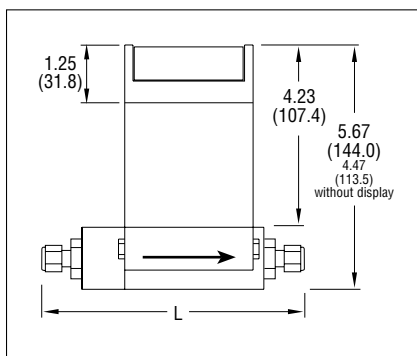

Model 820-S – Side View

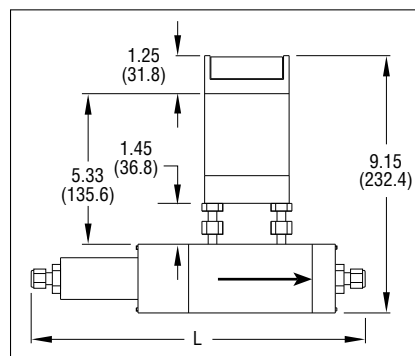

Model 820-S – Bottom View

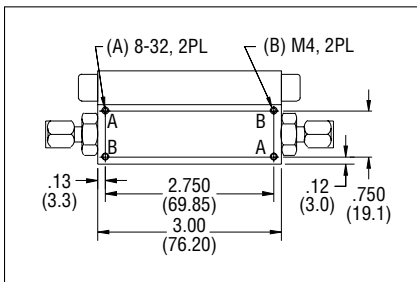

Model 820-S – Bottom View

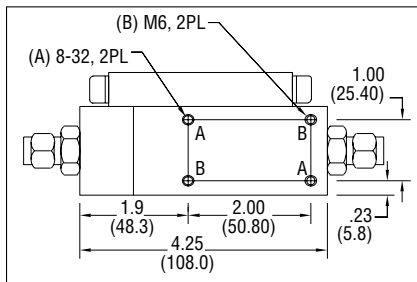

Model 820-S – Bottom View

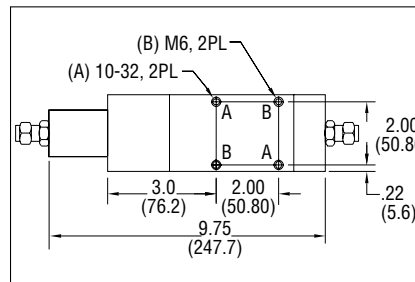

Model 820-S – Outlet View

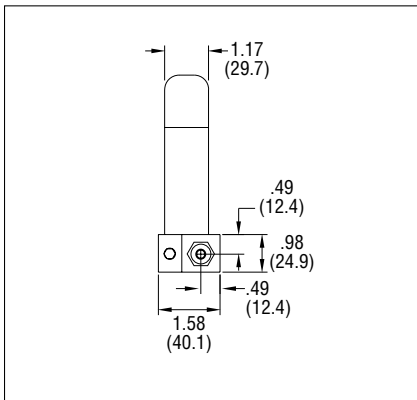

Model 820-S – Outlet View

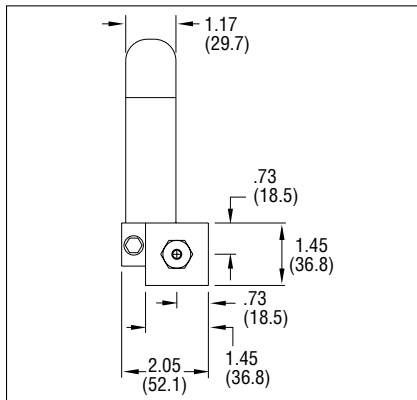

Model 820-S – Outlet View

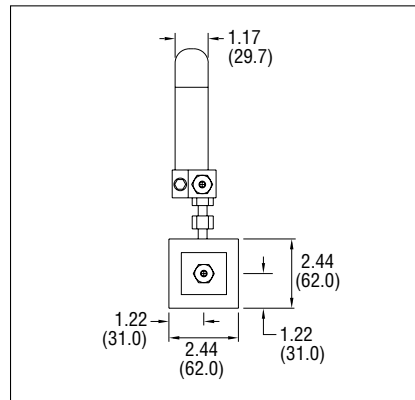

Performance Specifications

Accuracy

± 1.5 of full scale including linearity standard
± 1.0% of full scale (optional)

If the meter is mounted with a vertical (up or down) flow path the following full scale accuracy de-rating applies:

Inlet Pressure Deviation ²	OPERATING PRESSURE ¹		
	50 psig	100 psig	150 psig
± 1 psig	± 1.5%	± 1.5%	± 1.5%
± 5 psig	± 3.8%	± 4.5%	± 5.3%
± 10 psig	± 6%	± 7.5%	± 9%

Notes: (1) Do not exceed 150 psig.
(2) Difference between inlet pressure and calibrated pressure. Do not exceed ± 10 psig.

Repeatability

± 0.5% of full scale

Temperature Coefficient

±0.08% of full scale per °F (0.15% of full scale per °C), or better

Pressure Coefficient

±0.01% of full scale per psi (0.15% of full scale per bar) or better

Response Time

800 ms time constant; two seconds (typical) to within
± 2% of final value over 25 to 100% of full scale

Gas & Ambient Temperature

32 to 122°F (0 to 50°C)

Leak Integrity

5 X 10⁻⁹ atm cc/sec of helium maximum

Power Requirements

12 to 15 VDC, (15 VDC nominal), 100 mA maximum
24 VDC optional, specify when ordering

Output Signal

Linear 0–5 VDC, 1000 ohms minimum load resistance
Linear 4–20 mA, 500 ohms maximum loop resistance

Display (optional)

3.5 digit LCD (0.6 in H); removable for remote mounting

Physical Specifications

Wetted Materials

316 stainless steel, Viton® “O”-rings standard
Neoprene® and 4079 Kal-Rez® “O”-rings optional

Operating Specifications

Gases

Most gases; check compatibility with wetted materials; specify when ordering

Mass Flow Rates

0 to 10 sccm to 0 to 500 slpm; flow ranges specified are for an equivalent flow of nitrogen at 760 mm Hg and 21°C (70°F); other ranges in other units are available (e.g., scfh or nm³/h)

Gas Pressure

500 psig (34 barg) maximum;
30 psig (2 barg) optimum

Operating Specifications

PRESSURE DROP ACROSS THE 820S

Flow Meter	Flow Rate	Psi			Mbar		
		1/4	3/8	1/2	1/4	3/8	1/2
	Meter Fittings (inch): 	1/4	3/8	1/2	1/4	3/8	1/2
820S-L	100 sccm	.005	n/a	n/a	.309	n/a	n/a
820S-L	500 sccm	.006	n/a	n/a	.440	n/a	n/a
820S-L	1 slpm	.006	n/a	n/a	.475	n/a	n/a
820S-L	15 slpm	.11	.06	n/a	7.59	4.0	n/a
820S-M	20 slpm	.08	.03	n/a	5.50	2.0	n/a
820S-M	50 slpm	n/a	.3	.10	n/a	20.4	6.8
820S-M	100 slpm	2.0	.85	.30	136	58	20.4
820S-H	200 slpm	n/a	2.50	2.00	n/a	170	136
820S-H	500 slpm	n/a	n/a	8.5	n/a	n/a	578

Ordering the Model 820-S

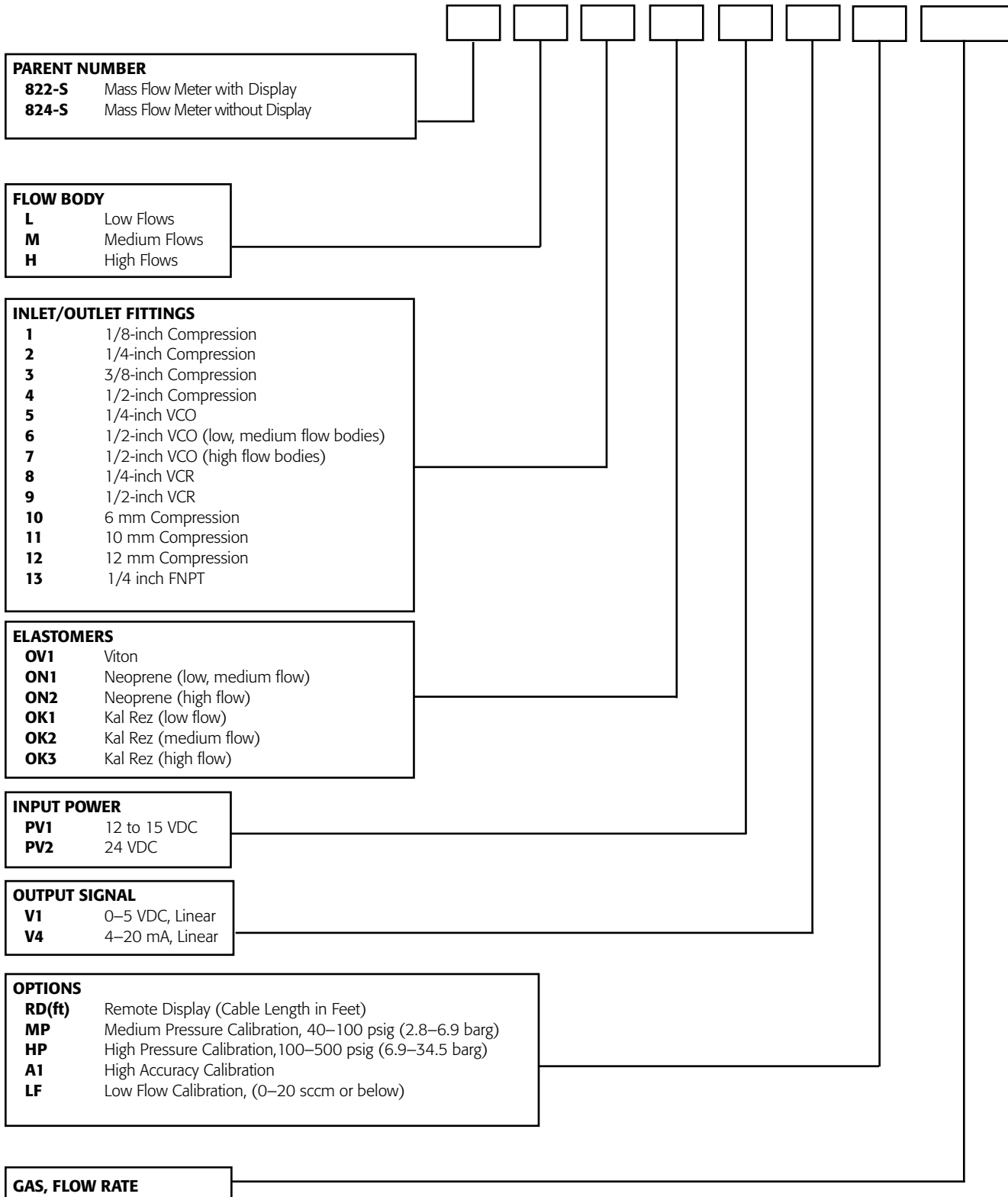

ACCESSORIES (Consult Factory)



SIERRA INSTRUMENTS, NORTH AMERICA • 5 Harris Court, Building L • Monterey, California • (800) 866-0200 • (831) 373-0200 • Fax (831) 373-4402 • www.sierrainstruments.com

SIERRA INSTRUMENTS, EUROPE • Bijlmansweid 2 • 1934RE Egmond aan den Hoef • The Netherlands • +31 72 5071400 • Fax: +31 72 5071401

SIERRA INSTRUMENTS, ASIA • Rm.618, Tomson Centre, Bldg. A • 188 Zhang Yang Road • Pu Dong New District • Shanghai, P.R. China 200122 • +8621 5879 8521/22 • Fax: +8621 5879 8586